

Signature Collection Options... Consider these optional ideas for your *Simplex* Waverly home...

- Alternate sidings
- The optional pre-designed Kitchen or Master Bath/Laundry Area plan
- Whirlpool jets for the Master Bath garden tub
- Alternate heating systems
- Bright brass bath accessories

- Andersen® "Tilt" windows in place of the "Narrowline" double hung windows
- Stained & finished interior doors and moldings
- Unfinished interior doors & moldings
- Additional appliances
- Merrillat® Maple or Cherry kitchen cabinetry
- Gourmet kitchen sink and/or faucet

- 2x10 Floor Joists, 16" o.c. with solid bridging
- Double 2x10 Mating girders-each module
- 3/4" T&G Plywood floor decking
- Armstrong®, no-wax vinyl floor coverings in the Kitchen and Baths
- 2x6 Exterior Walls, 16" o.c.
- 2x4 Interior Partitions, 16" o.c.
- Double 2x3 Mating Walls, 16" o.c.
- 1/2" Plywood sheathing at exterior walls and roof
- R-19 (6") exterior wall insulation
- CertainTeed® "Mainstreet" vinyl siding - 4/4 profile
- Insulated, fiberglass entry door
- Andersen®, white Patio Door(s)
- Andersen®, white "Narrowline" high performance windows
- Andersen® circle top window in the Master Bath
- Andersen® arched awning window in the Kitchen
- Combination 7/12 and 9/12 roof pitches, 16" o.c.
- 30 Year Architectural roof shingles
- Shingle over ridge vent
- Aluminum Fascia
- Vented vinyl soffits

- Specifications may be subject to change without prior notifications
- Renderings may include optional features
- Gable end overhangs
- R-38 (12") ceiling insulation
- Smooth finish, 1/2" drywall throughout - prime painted, white
- White painted, full profile colonial moldings throughout
- Fully trimmed closets
- Coated wire closet shelving
- Angled shoe shelving in the Master Bedroom closet
- White Decora switches, receptacles and cover plates
- Light blocks at exterior light fixtures
- Three exterior weatherproof receptacles on GFI circuit
- 40 breaker, 200 AMP panel box
- AC/DC smoke detectors per code
- GFI protected Kitchen & Bath circuits
- Baseboard electric heat with individual wall mounted thermostats
- Electric front door chime
- 50 gallon electric water heater
- Anti-scald shower mixing valves
- Single lever Kitchen and Bath faucets (chrome)
- Sink & toilet shut-off valves
- Copper fresh water supply lines
- P.V.C., schedule 40 drain, waste & vent piping

Signature Collection Standard Construction Specifications - The Waverly



Signature Collection

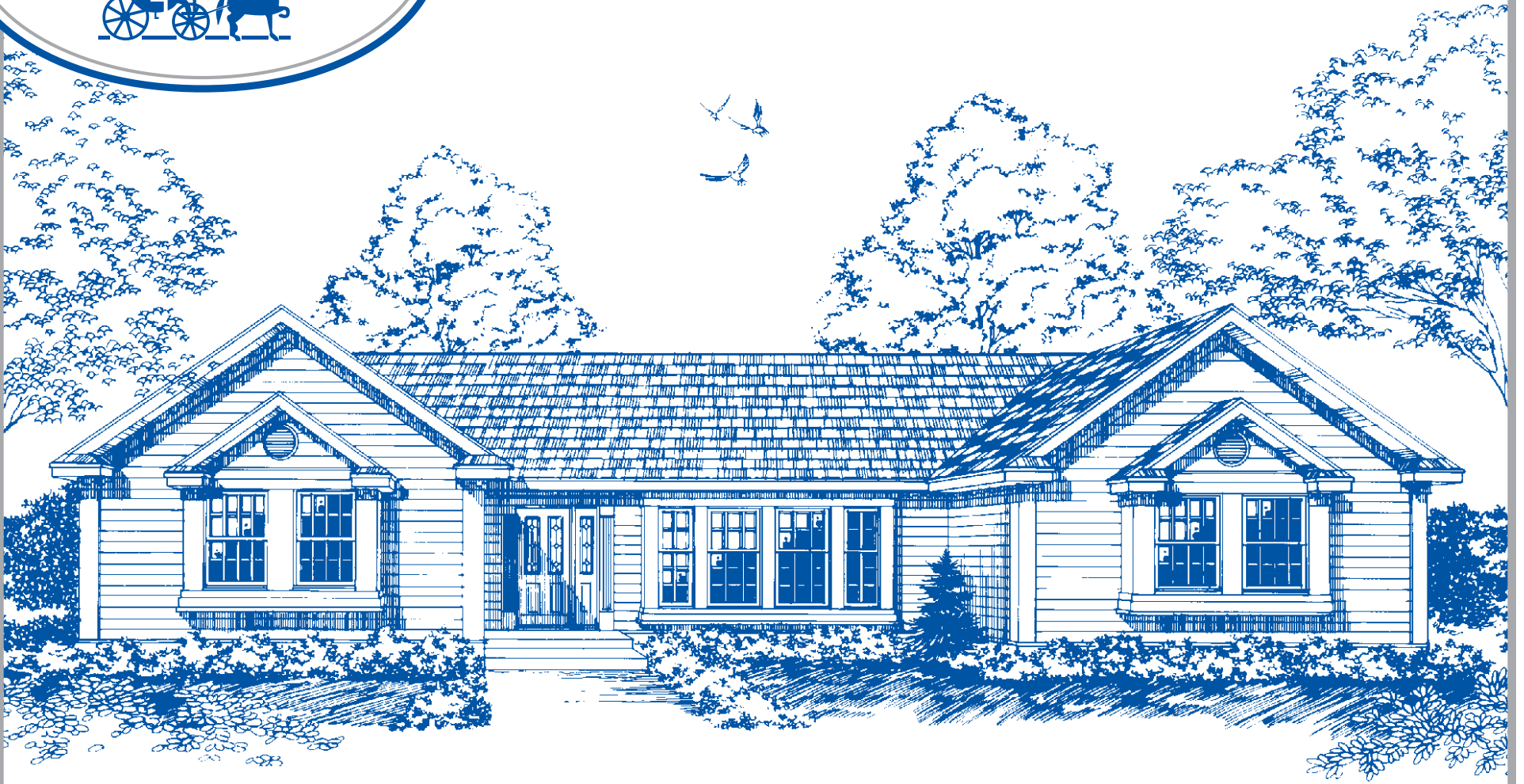

The Waverly

The Waverly Standard Exterior Features

- Architectural style roof shingles
- Shingled gable eave returns
- Boxed out front elevation windows with wide "PRIME TRIM" colonial finish detailing
- Wide "PRIME TRIM" trim boards at all outside corners
- Wide "PRIME TRIM" sill boards
- Frieze board and dentil moulding trim at all front elevation eave areas (also at Sunroom and BR 4 gable eaves of Waverly II model)
- Decorative circle vents above the boxed twin front windows

- Four panel style front door with two leaded glass inserts
- Single side-lite with leaded glass insert (to match door)
- Colonial mantle and fluted pilasters at the front door
- Wide, vinyl J-Channel at all gable and rear elevation windows
- Window grills for all windows and the Patio Door(s)
- Arched, awning casement kitchen window
- Circle top window above Master Bath dressing table
- Deluxe #1 brass exterior lights

The Waverly Standard Interior Features

- His and her slide-by mirrored closet doors in the Master Bedroom
- White colonial interior doors and mouldings
- Deluxe, bright brass lever-style interior locksets
- Three-sided PIER® gas fire place with glass doors and remote control
- Marble tile fireplace facing
- Entertainment area cabinetry with Merillat® raised panel oak cabinets and oak trim
- Upgrade carpeting and padding in the Dining Room, Nook, Sitting Room, Family Room, Hall and all Bedrooms
- Armstrong vinyl flooring in the Foyer
- 8 ft. ceiling height throughout the home with angled "tray soffit" ceiling in the Master Bedroom
- Deluxe #1 Brass Dining Room chandelier (on dimmer)
- Deluxe #1 hanging dining fixture in the Nook (on dimmer)
- Recessed ceiling lights in the Family Room (switched to 2 dimmers)
- Fluorescent light in the Kitchen
- Recessed lighting over the kitchen sink & snack bar
- Recessed ceiling lights in the Master Bedroom tray soffits (on dimmer)
- Two directional ceiling lights at the Family Room entertainment center (switched to dimmer)

- Kitchen features include:
 - Merillat® Raised Panel, Oak Arch cabinetry (choice of Seneca Ridge, Cider, Natural, Medium or Frost)
 - Self-edged countertops, with backsplash
 - Deep Stainless Steel Sink with spray
 - Tilt-out sink trays
 - Drawer base & lazy Susan base cabinets
 - 4-cycle dishwasher
 - Bar-height snack bar and overhang
- Bath features include:
 - Merillat® Arbor Falls vanity cabinetry
 - Four fixture color choices
 - Laminate bath tops with cultured china drop-in sinks in Master Bath & Powder Room
 - Cultured marble one-piece top/sink in Hall Bath
 - Plate glass mirror over Powder Room vanity and Master Bath Lav Sinks
 - Tri-view medicine chest over sink in Hall Bath
 - Light bars over mirrors in Master Bath
 - Elongated toilets (1.6 gallon watersaver)
 - Hooded, Acrylic tub/shower in Hall Bath
 - Hooded, Acrylic Shower in Master Bath compartment
 - Fiberglass garden style soaking tub in Master Bath
 - Hamper/linen cabinet in Master Bath compartment
 - Diagonal Accessory Garage, corner drawers and corner wall cabinet in the Master Bath

Please Note:

Each "Signature Collection" home includes architectural exterior treatments and premium interior features that make the most of the individual home plan. Because these home plans are specifically designed and priced to include numerous items that are traditionally considered upgrades, we can only allow limited floor plan modifications or elevation changes for these models.

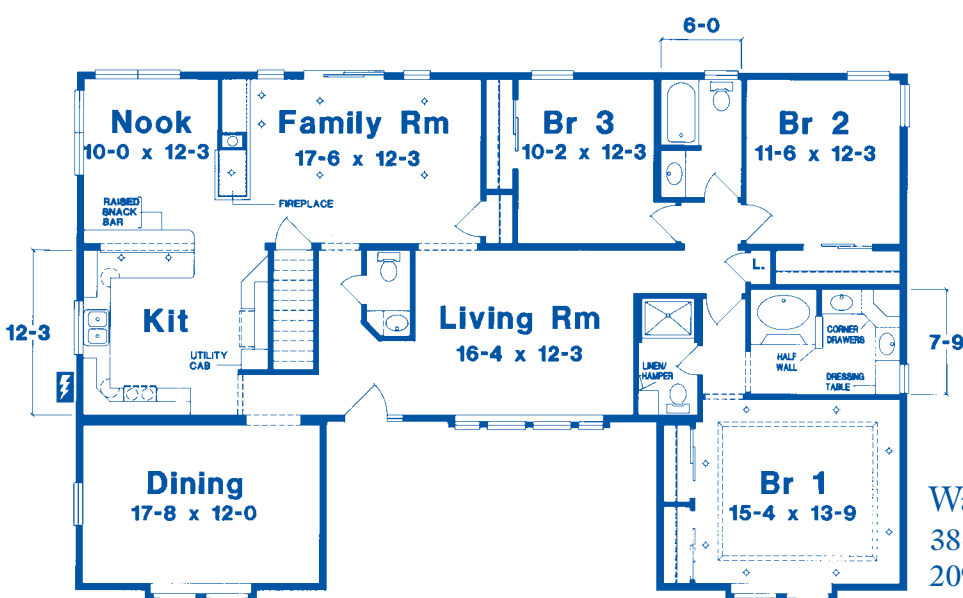

The Waverly

